

**VA A**

### 测量性能

DRYCAP® 180M  
DRYCAP® 180S

	2
	-60 ... +60 °C
1)	
DRYCAP® 180M	± 2 °C 2)

1) 0 °C DMT143L  
2)

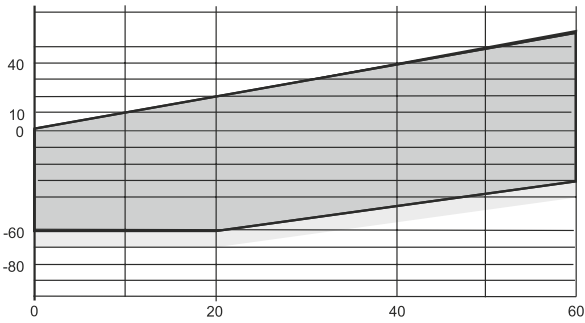

### 露点准确度与测量条件

	+20 °C	1 bar	1 /	63 %
[90 %]				
-60	-20 °C T <sub>d</sub>		5 s [10 s]	
-20	-60 °C T <sub>d</sub>		45 s [10 min]	
DRYCAP® 180S			± 2 °C 1)	

1) 0 °C

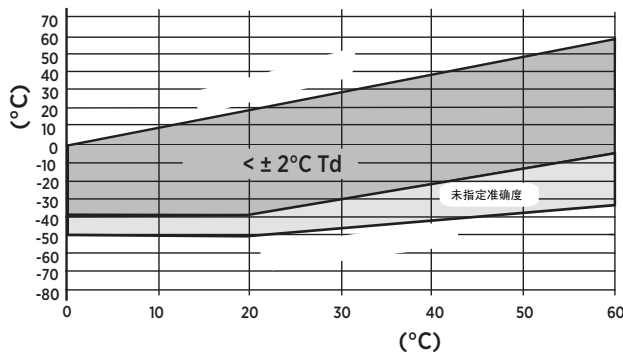

### 合规

IP	IP66
EMC	EN61326-1

### 工作环境

	0 ... +60 °C
	0 ... 100% RH
	0 ... 20bara
	-40 ... +60 °C

### 输入和输出

	4 ... 20mA
	RS-485
	Modbus RTU
	± 0.002 mA
+20 °C	± 0.05 mA
	500
	18 ... 28 VDC
	12 ... 28 VDC
	0.0008 mA/°C
24 VDC	220 mA

### 机械规范

	G1/2" ISO228-1	U
	NPT1/2"	
	(AISI 316L)	
重量		
G	90g	
NPT	100g	

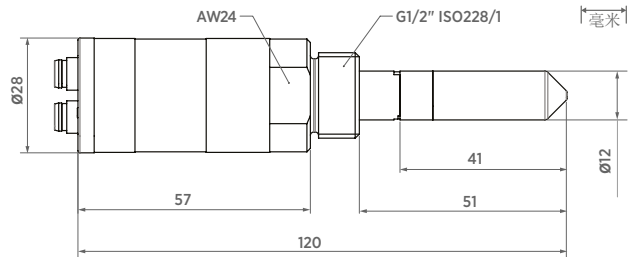

DMT143L G1/2"

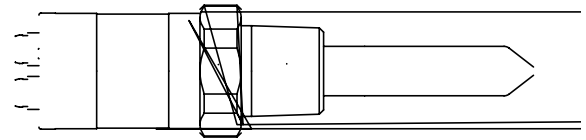

DMT143L NPT1/2"

